

Lightning 40 Outrunner Brushless Motor By Skyshark R/C

Features:

- Front and rear precision ball bearings for better efficiency and stronger performance.
- 81% Efficiency
- Heavy duty 5mm shaft
- RPM similar to glow motors
- 2 Year Warranty
- 2 Year Crash-Free Guarantee
(Motor replaced at 50% list price if damaged or crashed)

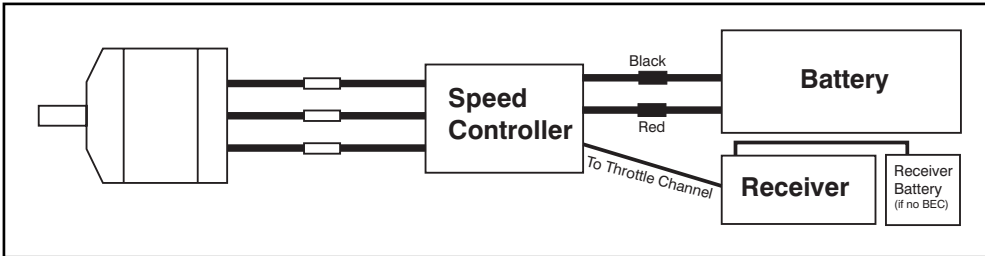
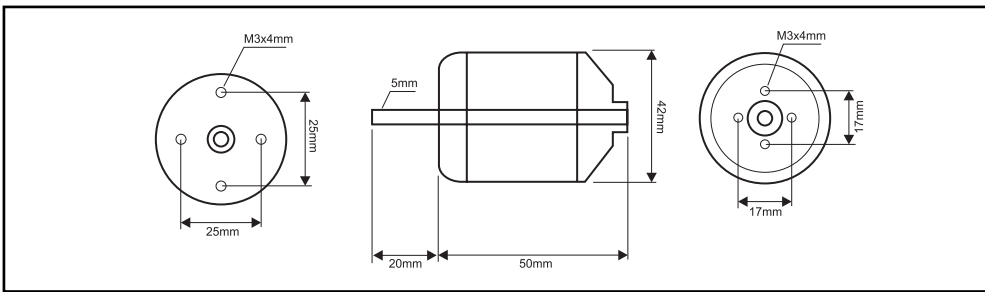

Model	Voltage Range	KV (RPM per Volt)	Weight	Operating Current	Max Current	ESC	Battery
Lightning 45HS	8-21	800	7.2 ounces	20 - 50	60	60 amp	4-5 LiPo

Connecting your motor:

1. Locate the 3 wires and remove the female end of the 4mm connector. Solder the female connectors on to your speed controller wires.
2. If front mounting the motor, connect the wires from your speed controller to the motor wire of the same color.
3. If using the optional motor mounting kit, reverse two wires on your speed controller (eg. the black wire on your speed controller will connect to the yellow motor wire and the yellow speed controller wire will connect to the black motor wire) This will insure the motor operates in the correct direction. You will not damage the motor by connecting the wires wrong. If you find the motor is not operating in the correct direction, simply switch two of the wires. If using a Skyshark Ultra speed controller, you can connect the wires in order and program the motor to run in the correct direction later.
4. Refer to your speed controller documentation for instructions on connecting your speed controller and battery. If you plan to mount this motor to an existing firewall, you will need to purchase the SBA40 Firewall Mount.

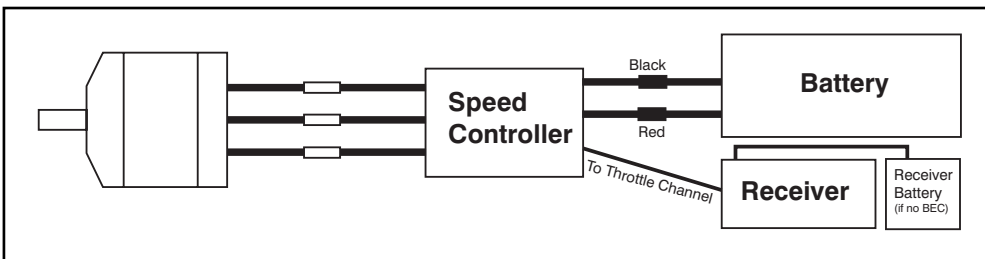
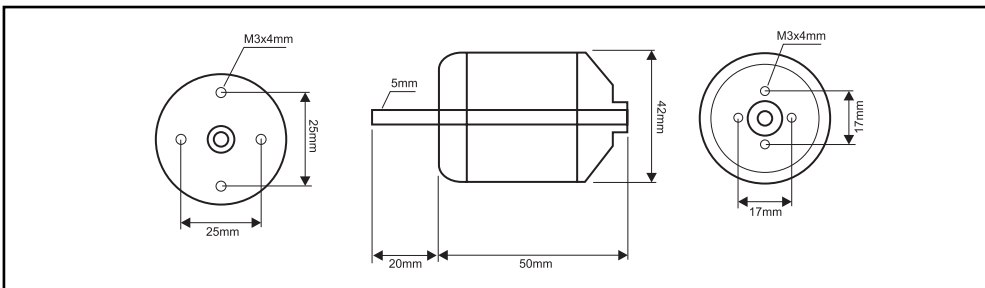

Model	Voltage Range	KV (RPM per Volt)	Weight	Operating Current	Max Current	ESC	Battery
Lightning 45HS	8-21	800	7.2 ounces	20 - 50	60	60 amp	4-5 LiPo

Connecting your motor:

1. Locate the 3 wires and remove the female end of the 4mm connector. Solder the female connectors on to your speed controller wires.
2. If front mounting the motor, connect the wires from your speed controller to the motor wire of the same color.
3. If using the optional motor mounting kit, reverse two wires on your speed controller (eg. the black wire on your speed controller will connect to the yellow motor wire and the yellow speed controller wire will connect to the black motor wire) This will insure the motor operates in the correct direction. You will not damage the motor by connecting the wires wrong. If you find the motor is not operating in the correct direction, simply switch two of the wires. If using a Skyshark Ultra speed controller, you can connect the wires in order and program the motor to run in the correct direction later.
4. Refer to your speed controller documentation for instructions on connecting your speed controller and battery. If you plan to mount this motor to an existing firewall, you will need to purchase the SBA40 Firewall Mount.

Lightning 40 Outrunner Brushless Motor By Skyshark R/C

Features:

- Front and rear precision ball bearings for better efficiency and stronger performance.
- 81% Efficiency
- Heavy duty 5mm shaft
- RPM similar to glow motors
- 2 Year Warranty
- 2 Year Crash-Free Guarantee
(Motor replaced at 50% list price if damaged or crashed)

Lightning 40 3 cell 11.1 volt Skyshark Ultra LiPo Battery Skyshark Ultra 70 Controller Timing 15 degrees			
Prop (APC)	RPM	Amps	Watts
11 x 5.5	9600	25	280
11 x 8	8500	31	360
12 x 6	8400	32	365
12 x 8	7900	39	430
12 x 10	7400	45	490
13 x 6	7800	40	440
13 x 8	7100	51	500
14 x 7	7200	49	510

For 5S use 9x6, 10x6 or 11x5 prop

The above numbers are static measurements. In flight, amp draw will decrease approx 10 -15% and RPMs will increase slightly. Shaded area indicates max efficiency - for best performance use these prop sizes. Always use a watt meter to test your system's performance and amp draw before the first flight.

- For maximum power, set your computer radio's throttle setting to 140%
- Use of 30 degree timing on your speed controller will increase the rpm and amp draw and decrease the motor's efficiency
- **Always balance your prop.** Using a prop that is out of balance will cause bearing and shaft damage that is not covered under warranty.



Skyshark R/C Corporation
1924 N. Pima Drive
Lake Havasu City, AZ 86403
Tel: (928) 854-6100
Website: www.skysharkrc.com
email: cservice@skysharkrc.com

Lightning 40 4 cell 14.8 volt Skyshark Ultra LiPo Battery Skyshark Ultra 70 Controller Timing 15 degrees			
Prop (APC)	RPM	Amps	Watts
10 x 6	11,000	29	420
10 x 8	10,400	33	465
11 x 5.5	10,600	36	505
11 x 8	10,000	44	600
12 x 6	9900	45	610
12 x 8	9200	52	720
13 x 6	9100	53	730
13 x 6.5	9000	56	750

Manufacturer's Warranty

This product is warranted against manufacturer's defects in materials and workmanship for a period of 2 years from the date of purchase. Products covered by this warranty will be replaced at no charge upon inspection of the defective item. Not covered under this warranty are defects resulting from misuse, abuse, modification, alteration or any type of damage. See our website for complete warranty details.

Lightning 40 3 cell 11.1 volt Skyshark Ultra LiPo Battery Skyshark Ultra 70 Controller Timing 15 degrees			
Prop (APC)	RPM	Amps	Watts
11 x 5.5	9600	25	280
11 x 8	8500	31	360
12 x 6	8400	32	365
12 x 8	7900	39	430
12 x 10	7400	45	490
13 x 6	7800	40	440
13 x 8	7100	51	500
14 x 7	7200	49	510

For 5S use 9x6, 10x6 or 11x5 prop

The above numbers are static measurements. In flight, amp draw will decrease approx 10 -15% and RPMs will increase slightly. Shaded area indicates max efficiency - for best performance use these prop sizes. Always use a watt meter to test your system's performance and amp draw before the first flight.

- For maximum power, set your computer radio's throttle setting to 140%
- Use of 30 degree timing on your speed controller will increase the rpm and amp draw and decrease the motor's efficiency
- **Always balance your prop.** Using a prop that is out of balance will cause bearing and shaft damage that is not covered under warranty.



Skyshark R/C Corporation
1924 N. Pima Drive
Lake Havasu City, AZ 86403
Tel: (928) 854-6100
Website: www.skysharkrc.com
email: cservice@skysharkrc.com

Lightning 40 4 cell 14.8 volt Skyshark Ultra LiPo Battery Skyshark Ultra 70 Controller Timing 15 degrees			
Prop (APC)	RPM	Amps	Watts
10 x 6	11,000	29	420
10 x 8	10,400	33	465
11 x 5.5	10,600	36	505
11 x 8	10,000	44	600
12 x 6	9900	45	610
12 x 8	9200	52	720
13 x 6	9100	53	730
13 x 6.5	9000	56	750

Manufacturer's Warranty

This product is warranted against manufacturer's defects in materials and workmanship for a period of 2 years from the date of purchase. Products covered by this warranty will be replaced at no charge upon inspection of the defective item. Not covered under this warranty are defects resulting from misuse, abuse, modification, alteration or any type of damage. See our website for complete warranty details.